



Characteristics

TGCL is an end suction radial type pump, from DN65 up to DN150, manufactured in EN-GJL-250 or EN-GJS-400 Cast iron with IP56 protection.

TGCL pumps perform with low noise levels, measured on free-field hemispherical surface and validated at our laboratory.

The pumps are supplied, as standard, with C5 H surface treatment (high durability - 320 µm) according to ISO 12944:2018. They can be installed horizontally or vertically with the possibility of motor housing being rotated in 90° angles, with terminal box and drain/vent plugs position defined according to order. Flanges can be DIN or ISO PN10, raised or flat faced. They offer the possibility of having multiple motors of choice, either 4 or 6 poles, with hydraulic performance curves that will match the requirements of any project.

Parts	Materials
Casing	EN-GJL-250 or EN-GJS-400
Impeller	EN-GJL-250 or EN-GJS-400
Shaft	AISI420
Terminal Box	Aluminium Al Si10 Mg
Screws	A4 – AISI316

Electrical data	
Power	0,75 up to 7,5 kW
Poles	4/6
Voltages	3x400 VAC @ 50 Hz or 3x460 VAC @ 60 Hz

Part list

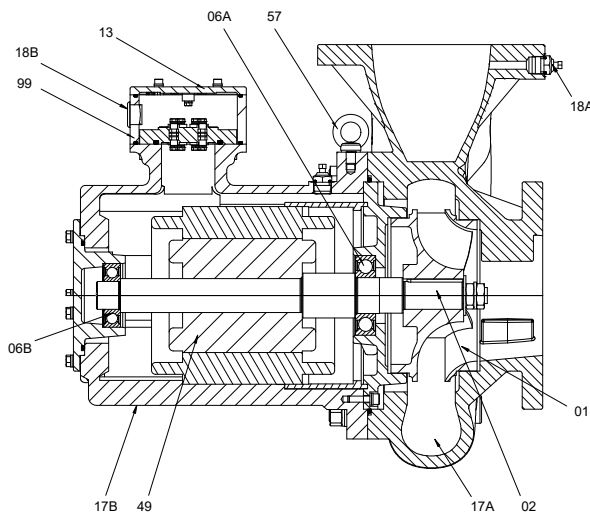

Part	Designation
01	Impeller
02	Shaft
06A	Bearing
06B	Bearing
13	Terminal box cover
17A	Pump casing
17B	Motor casing
18A	Drain/ vent
18B	Cable gland
49	Motor
57	Eye bolt
99	Terminal box

Curves According to ISO 9906 Grade 2B/ EN 50216-7

50 Hz

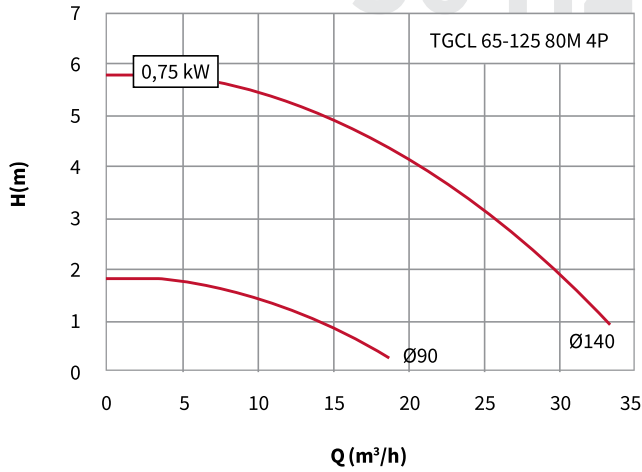

60 Hz

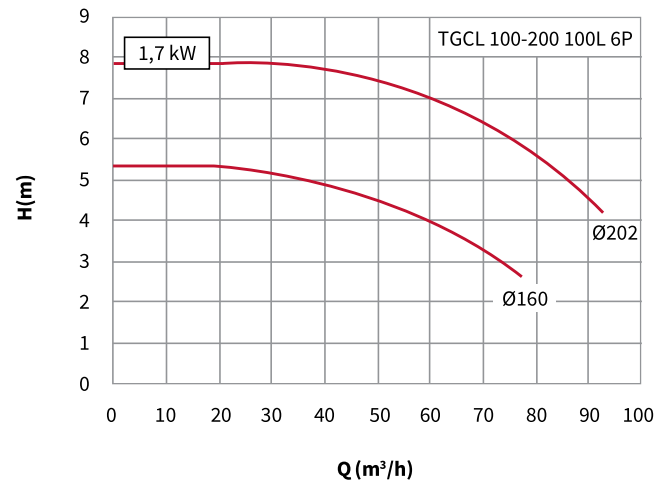
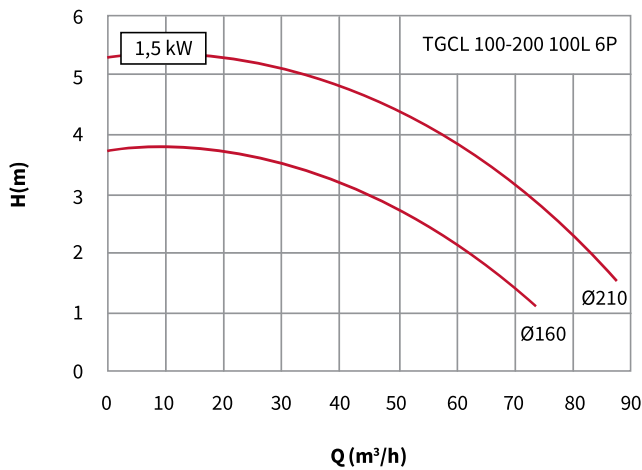
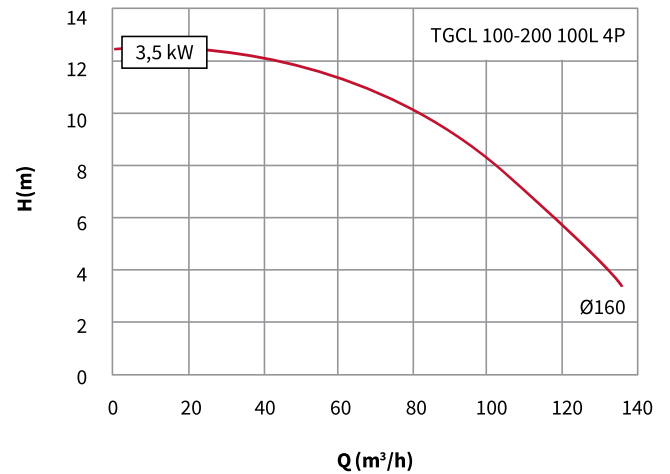
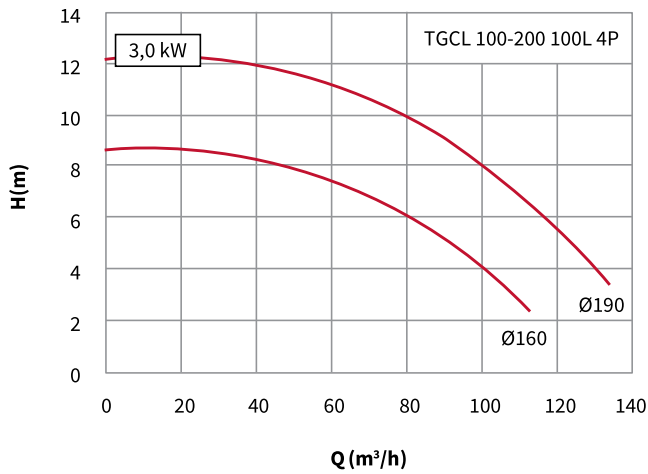
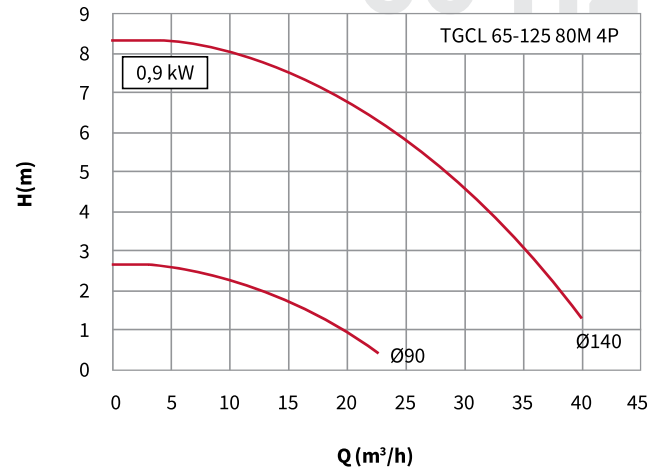

50 Hz

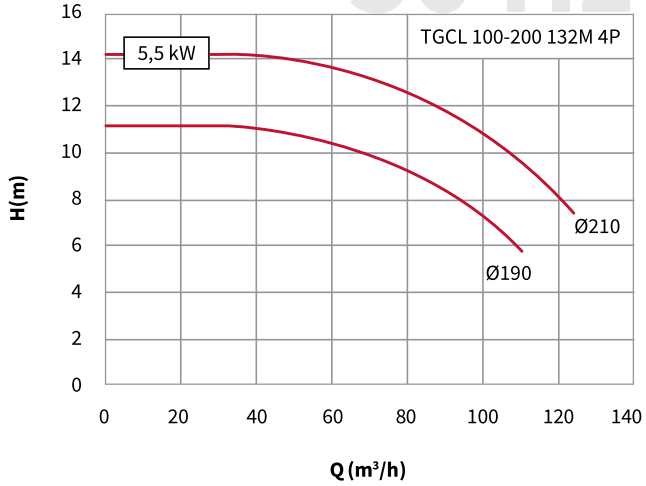

60 Hz

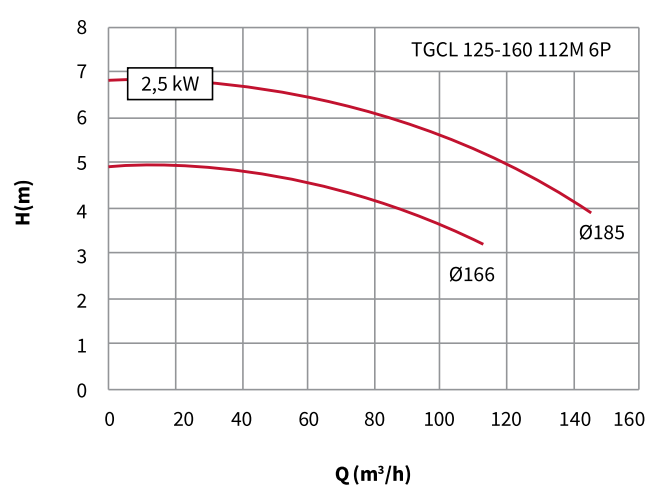
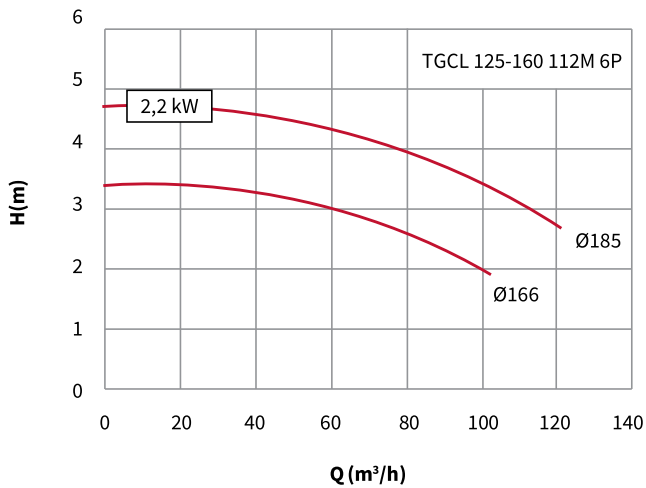
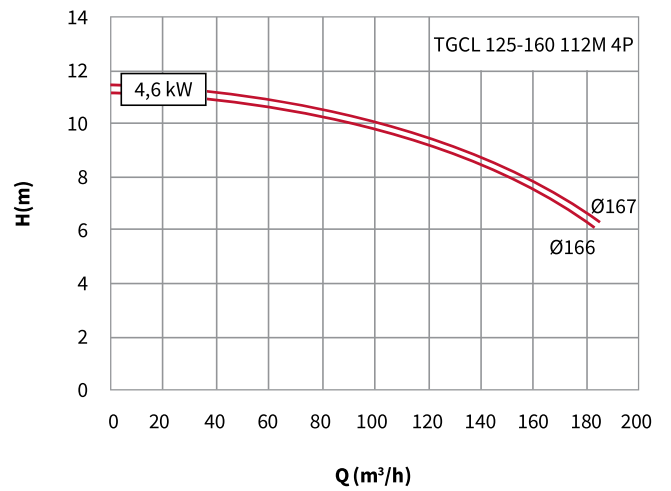
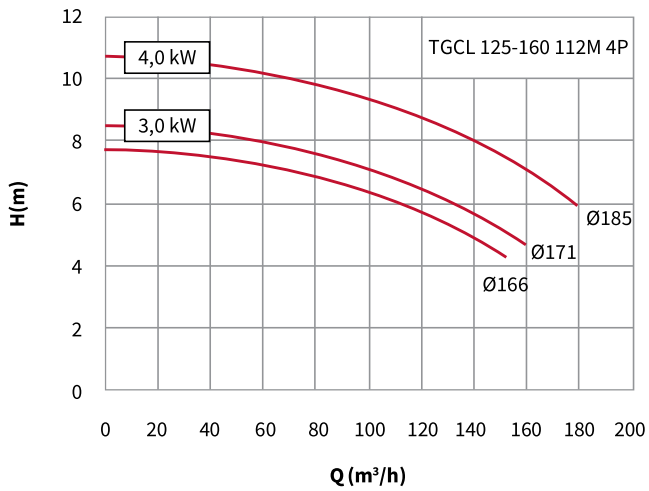
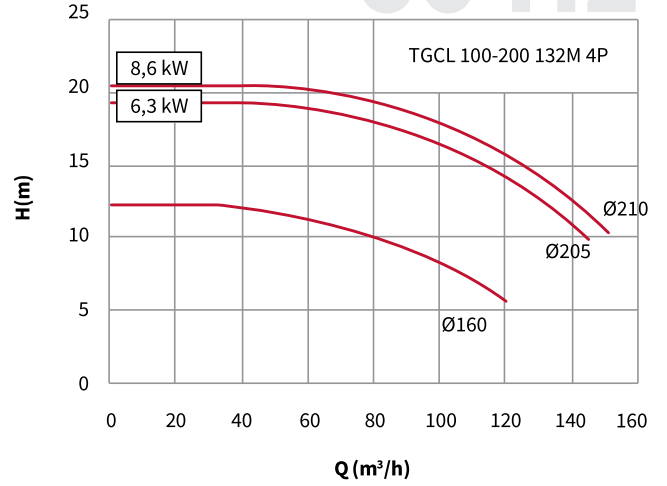

50 Hz

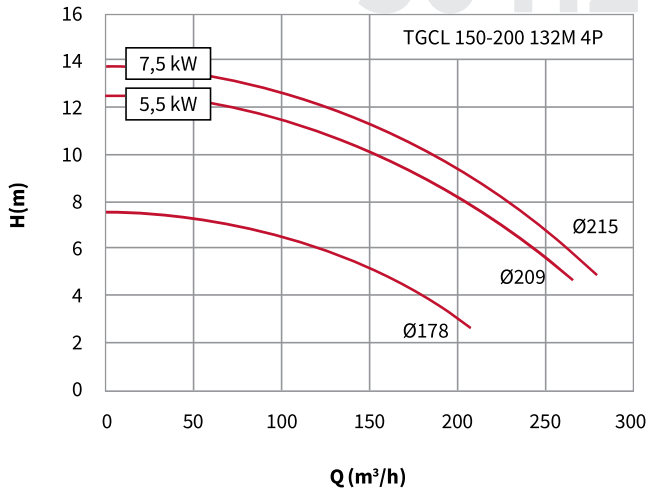

60 Hz

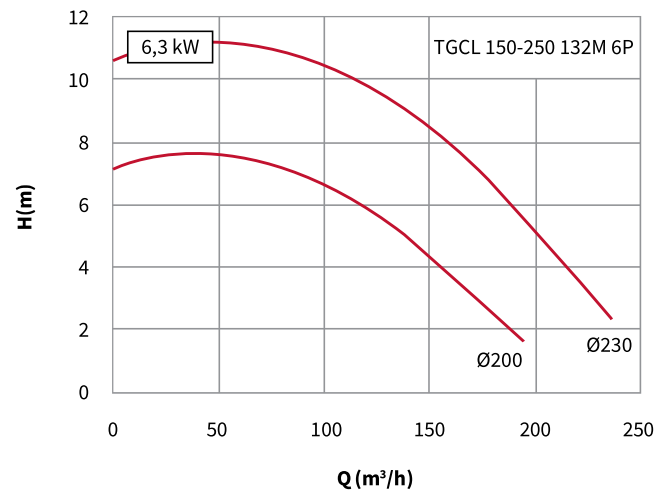
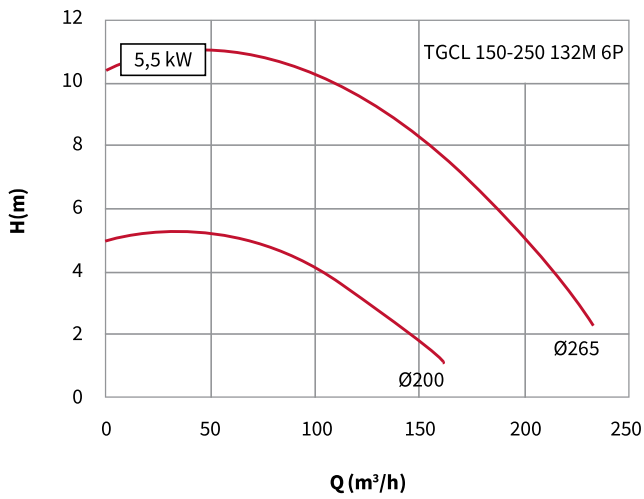
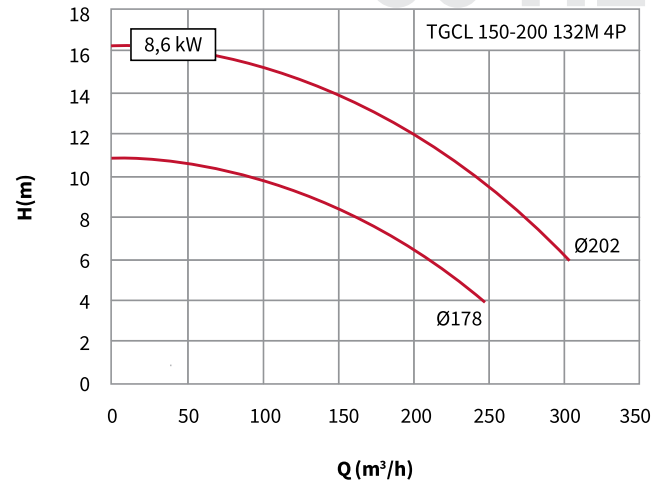

Dimensions (mm)

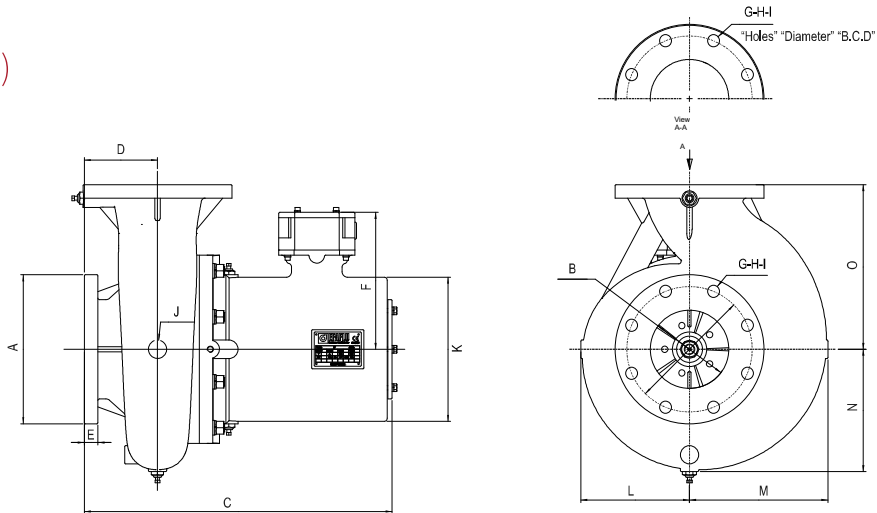

Pump	A	B	C	D	E	F	G	H	I	J	K	L	M	N	O	Weight (Kg)
TGCL 65-125 80M	185	65	392	86	18	206	4	18	145	35	171	113	121	113	150	55
TGCL 100-200 100L	220	100	524	125	24	236	8	18	180	35	211	155	188	173	250	120
TGCL 100-200 132M	220	100	559	125	24	262	8	18	180	35	276	180	188	180	250	160
TGCL 125-160 112M	250	125	559	125	26	247	8	18	210	35	235	181	221	202	280	145
TGCL 150-200 132M	285	150	589	140	26	262	8	23	240	35	276	208	265	234	315	195
TGCL 150-250 132M	285	150	574	140	26	262	8	23	240	35	276	211	262	237	355	190

Motor

Motor	Poles	Frequency (Hz)	Voltage (V)	Power (kW)	Cos Φ	Inom (A)	Ia (A)	Eff. class
0,75	4	50	400	0,75	0,70	1,9	12,4	IE3
		60	460	0,90	0,70	1,9	11,9	
1,5	6	50	400	1,5	0,71	3,7	19,2	
		60	460	1,7	0,71	3,7	28,0	
2,2	6	50	400	2,2	0,72	5,3	29,2	
		60	460	2,5	0,72	5,3	18,5	
3	4	50	400	3,0	0,78	6,4	51,8	
		60	460	3,5	0,78	6,4	49,8	
4	4	50	400	4,0	0,82	8,0	68,0	
		60	460	4,6	0,82	8,0	65,3	
5,5	4	50	400	5,5	0,84	10,6	95,4	
		60	460	6,3	0,84	10,6	91,6	
	6	50	400	5,5	0,75	12,1	90,8	
		60	460	6,3	0,75	12,1	87,1	
7,5	4	50	400	7,5	0,85	14,1	126,9	
		60	460	8,6	0,85	14,1	121,8	